

An architectural rendering of a modern, multi-story building designed as a shelter for mothers with children. The building features a light-colored facade and multiple levels with red-tinted balconies. Large trees are planted around the building, and a paved plaza in the foreground is populated with people: a man and a woman standing, a woman sitting on a wooden bench, a person skateboarding, and a woman pushing a stroller with a child. To the right, a modern staircase with a glass railing leads to an upper level where more people are visible. The overall atmosphere is bright and open.

# SHELTER FOR MOTHERS WITH KIDS

ING. ARCH. KAROLÍNA KRIPNEROVÁ

Seminář Cesty z bezdomovectví  
2.10.2015 Praha



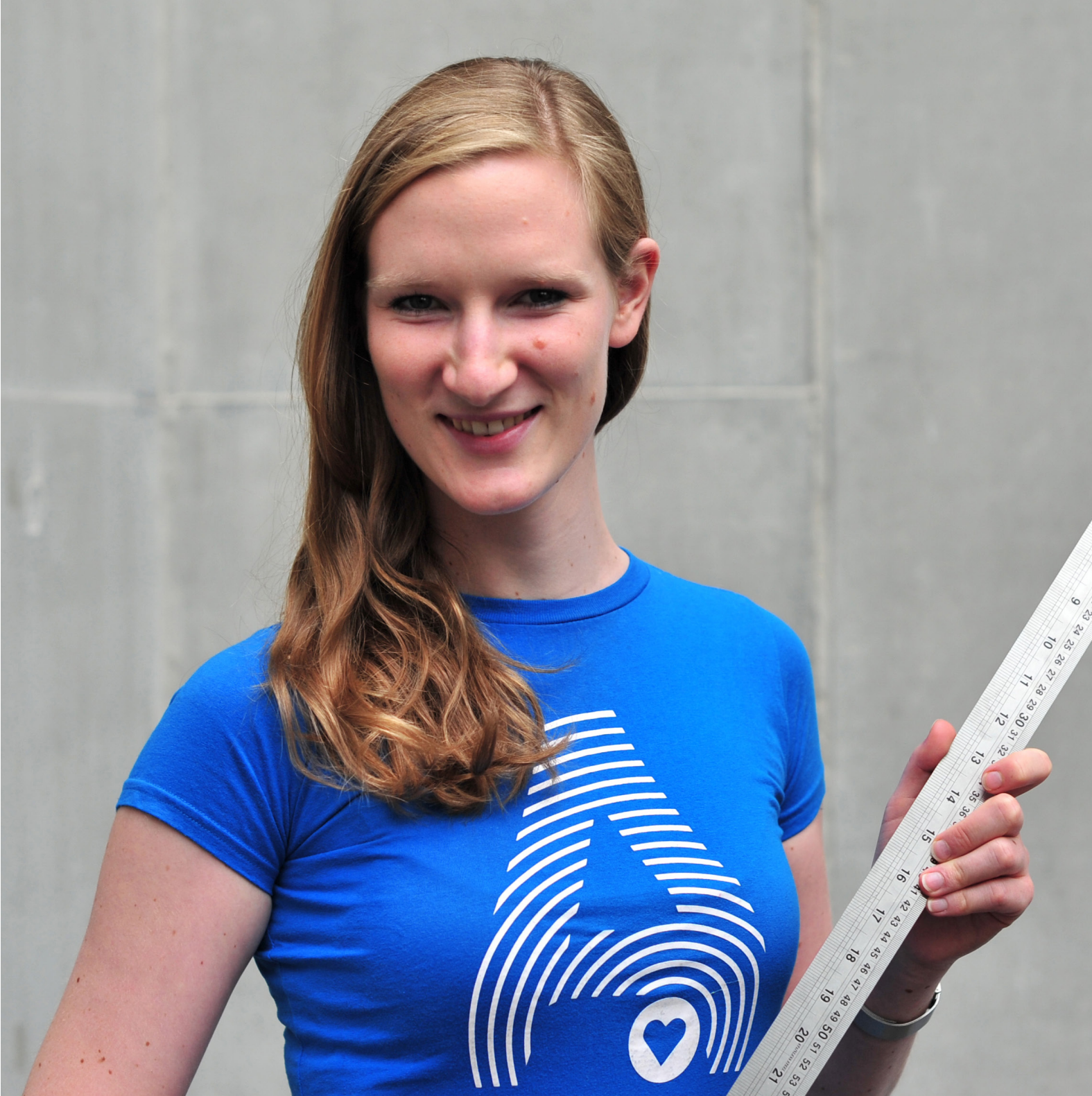

# KAROLÍNA KRIPNEROVÁ

karolina.kripnerova@gmail.com

+420 728 889 234

## WORK

- |            |  |
|------------|--|
| 2015       | Architects without Borders, Prague     |
| 2014       | Schnetzerpils Architekten GmbH, Vienna |
| 2013 - now | Martin Cenek Architecture, Prague      |
| 2013       | Solar Decathlon: Team Czech Republic   |

## STUDIES

- |             |  |
|-------------|--|
| 2015        | PhD. research studies at FA CTU, Prague<br>(social sustainability from an architectural point of view) |
| 2009 - 2015 | MA (ing. arch.) degree, FA CTU, Prague   |
| 2012 - 2013 | FA RWTH, Aachen (DE)   |

# STRUCTURE

RESEARCH: HOMELESSNESS  
SHELTERS IN PRAGUE  
INSPIRATIONS FROM VIENNA  
PLACE FOR A SHELTER?  
DESIGN

# RESEARCH: HOMELESSNESS

LAIC POINT OF WIEV

SHELTERS IN PRAGUE

INSPIRATIONS FROM VIENNA

PLACE FOR A SHELTER?

DESIGN



Petr Smékal  
57 years  
Technical university  
Ing.  
3 years on the street

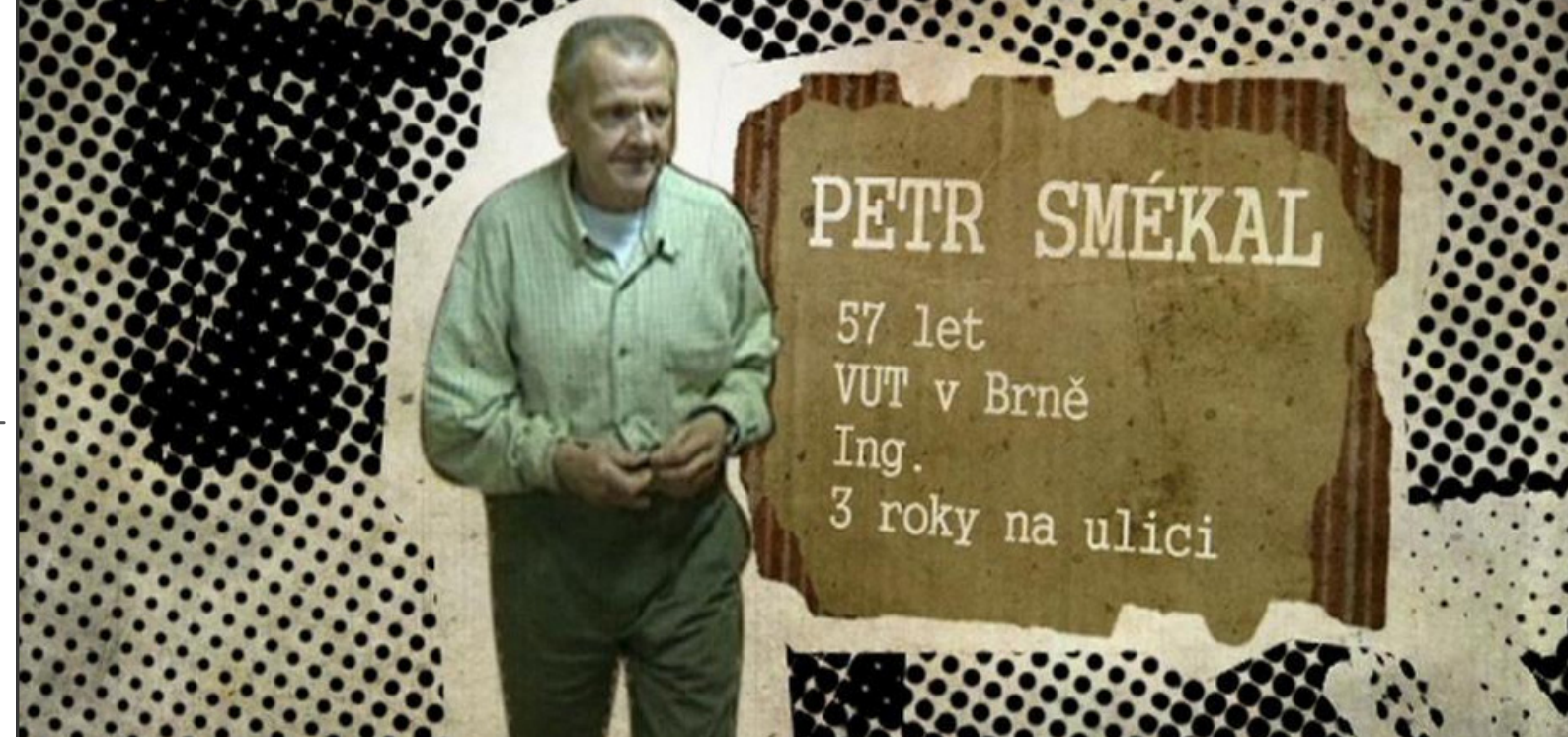

Vladimír Kršijak  
57 years  
Law university  
JUDr..  
5 years on the street



Jaroslav Mikloška  
60 years  
Technical university  
Ing.  
5 years on the street



## CAUSE OF HOMELESSNESS

1. material and social
2. health
3. "to be bad born"

It can happen to everybody.





Spikes in the public places, Brno, CZ

## HOW TO BEHAVE?

1. extreme *knockback*
2. "guerilla" *trash shelter*
3. systematic solve *hierarchy of social help*

Everybody makes the decision on his own.



Trash shelters, California, USA





Terénní programy ATK Liberec



Nízkoprahové centrum v Otrokovicích



Noclehárna Hermes, Praha

## HIERARCHY OF SOCIAL HELP

1. street programme
2. day centres
3. dosshouses
4. shelters
5. social housing

Shortage.



## SITUATION IN PRAGUE IN FIGURES

There are around 4.000 homeless people.

1.500 obvious / 2.500 hidden

Prognosis for 2020: 13.000 people on the street.

Increasing numbers.



Walking in another man's shoes, Andrew Schneipp



FOR WHO?

Mothers with kids on the street.  
A shelter.



Fa Drtikol a spol: Mother with a kid, 1919

RESEARCH: HOMELESSNESS  
SHELTERS FOR MOTHERS WITH KIDS  
PRAGUE NOW  
INSPIRATIONS FROM VIENNA  
PLACE FOR A SHELTER?  
DESIGN



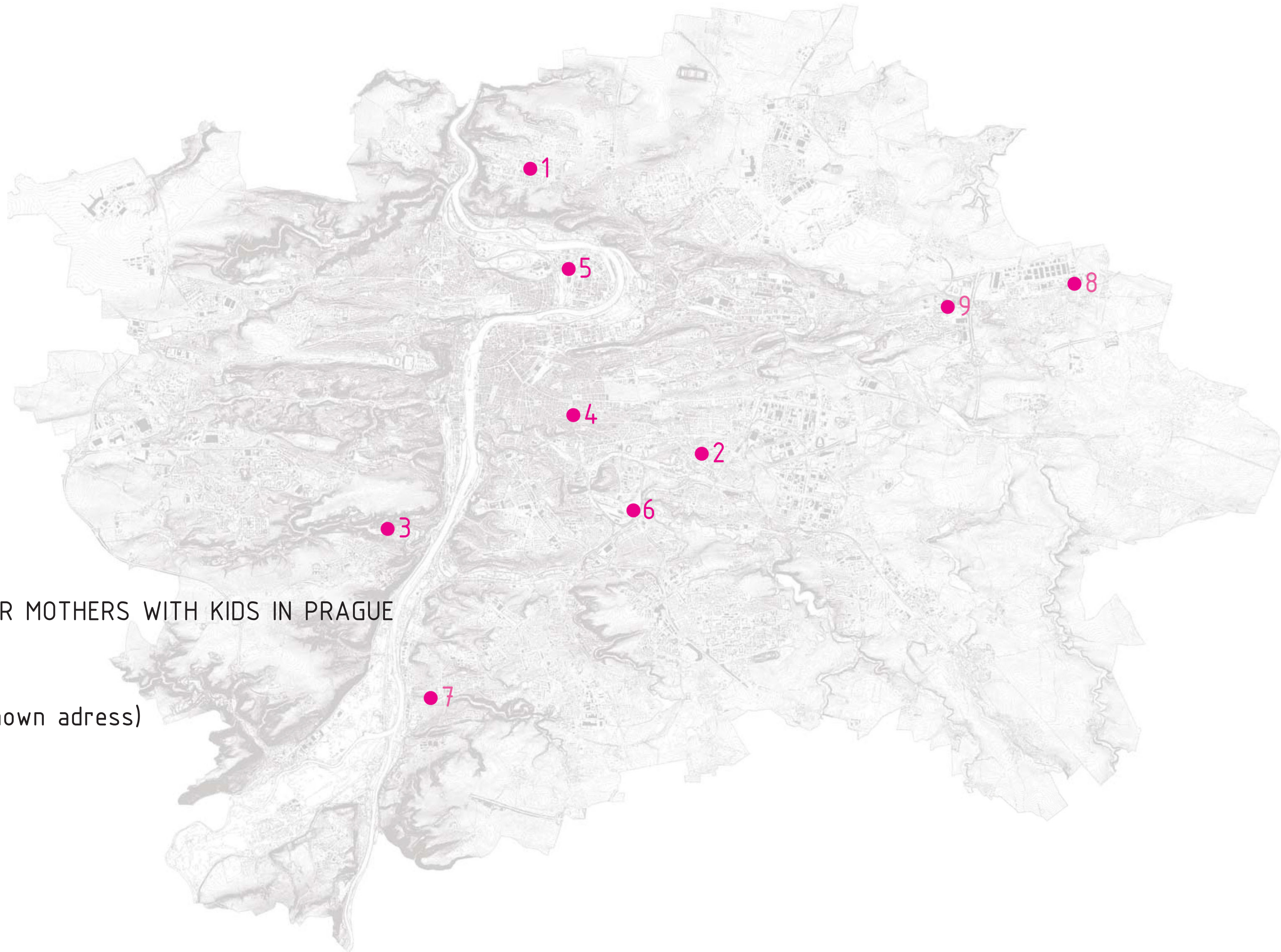

SHELTER FOR MOTHERS WITH KIDS IN PRAGUE

11 places  
(2 with unknown adress)

300:800  
Deficiency.





Renolrova Shelter (Google Streetview)



Varšavská Shelter (Google Streetview)



Za Papírnou Shelter (Google Streetview)

## APPEARANCE

Closed doors and stand-off from the society.

## MOTHERS

Debt problems

Lack of qualifications

Lack of baby sitting

No knowledge of how to behave in society.



RESEARCH: HOMELESSNESS  
SHELTERS FOR MOTHERS WITH KIDS  
**INSPIRATION FROM VIENNA**  
VINZI RAST MITTENDRIN + LOKAL  
PLACE FOR A SHELTER?  
DESIGN



Interior of the restaurant



After the reconstruction



Before the reconstruction

## VINZIRAST MITTENDRIN + LOKAL

Citycenter of Vienna  
 Both homeless and students living together  
 Gaupenraub (Alexander Hagner, Ulrike Schartner)

Unprecedented example of a social architecture.





VinziBus: Food and Warm



Vinzi Shop: cheap clothes



VinziPasta: Project in Hostice, Slovak Republic

SOCIETY OF SAINT VINCENT DE PAUL

Founded 1833 in Paris, Sorbonna  
Helping impoverished people  
1990 in Austria: VinziGemeinschaft

Nowadays 38 VinziWerke in Austria.



VINZIDORF: GRAZ – WIEN

35 male guests, alcohol addicted  
staff: only volunteers  
no more homeless people in Graz.

30.10. + 31.10 Open house – Graz.





RESEARCH: HOMELESSNESS  
SHELTERS FOR MOTHERS WITH KIDS  
INSPIRATION FROM VIENNA  
**RIGHT PLACE FOR A SHELTR**  
PRAGUE, ARCHITECTURAL POINT OF VIEW  
DESIGN





## MAIN REQUESTS

1. abandoned house: continuity of a story
2. prominent „hipster“ part of Prague
3. public transport access
4. visibility





Prague 7 -HOLEŠOVICE- PLYNÁRNÍ street

Abandoned house  
Tram station  
Diverse surroundings

Photo of today stand





Slán

na postavení kanceláří, skladisté a kuchyní st domu č.p. 899 v Plynární ul. v Praze VII

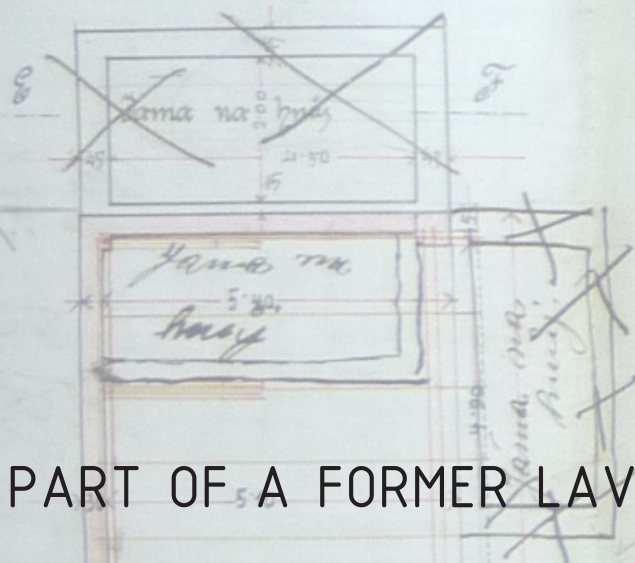
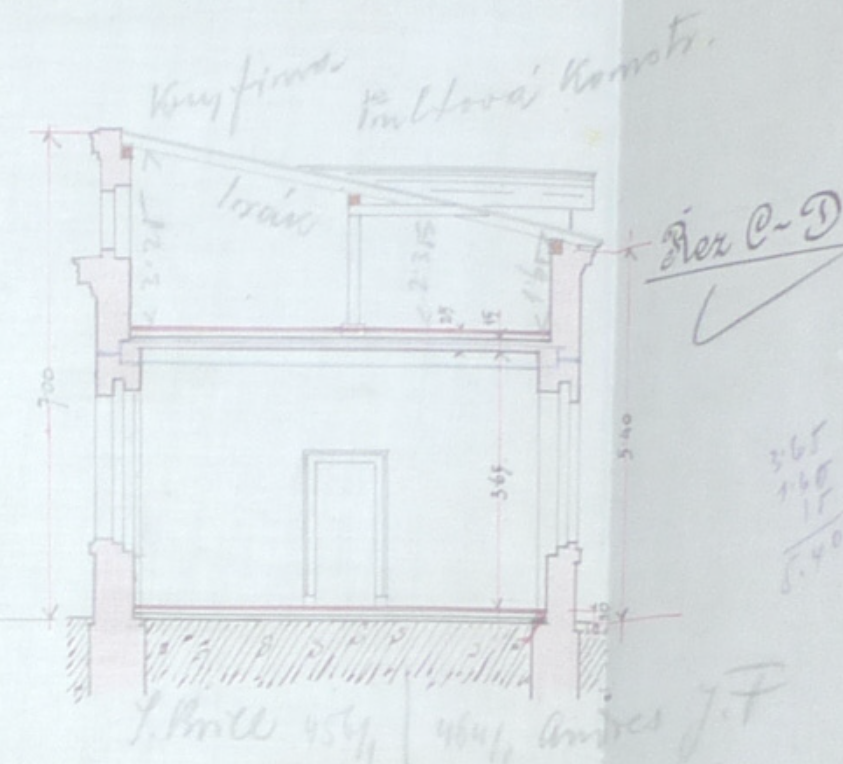

Řez A-B

Situace

1:120

Blocha parc.č. 95% a 464, měří: 152219m<sup>2</sup>  
z toho dříve zastavěno: 53181m<sup>2</sup>  
nově zastavěno: kolna 8640.  
přední stavení 21490 83311m<sup>2</sup>  
zbylá nezastavěno 68908m<sup>2</sup>

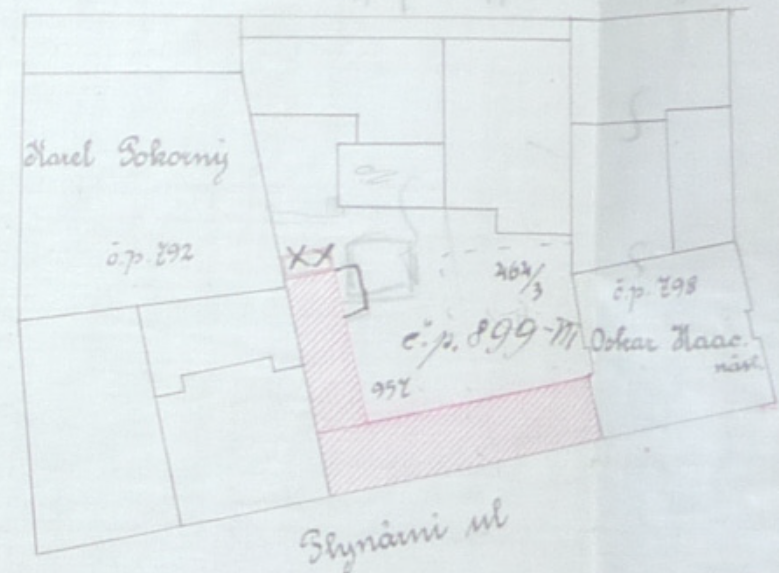

A PART OF A FORMER LAVATORY OF OSKAR HAAC

"Never demolish, never remove or replace, always add, transform and reuse!"

(Frédéric Druot, Anne Lacaton + Jean-Philippe Vassal)

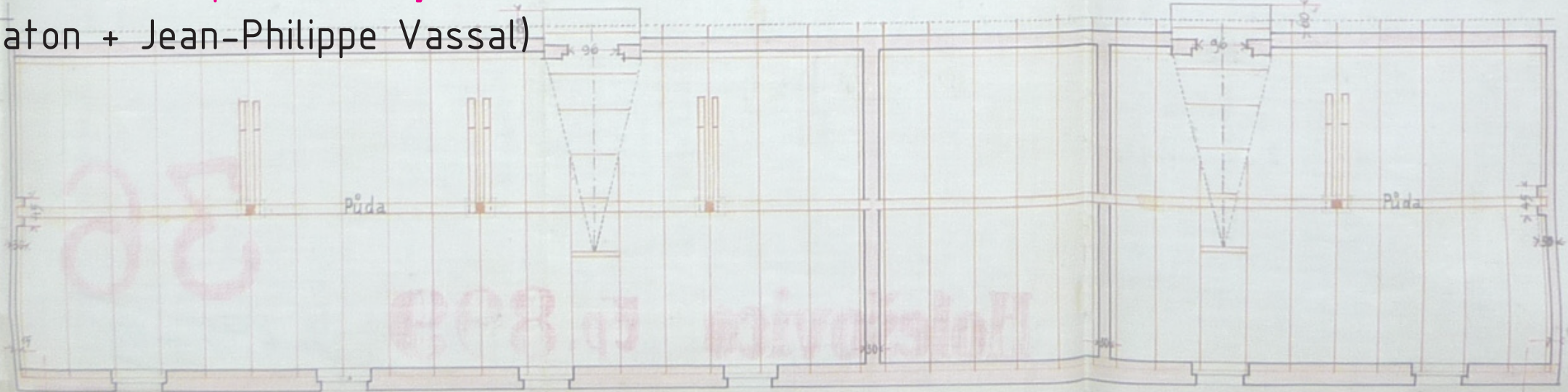



RESEARCH: HOMELESSNESS  
SHELTERS FOR MOTHERS WITH KIDS  
INSPIRATION FROM VIENNA  
RIGHT PLACE FOR A SHELTR  
**DESIGN OF A SHELTR**  
ARCHITECTURAL POINT OF VIEW



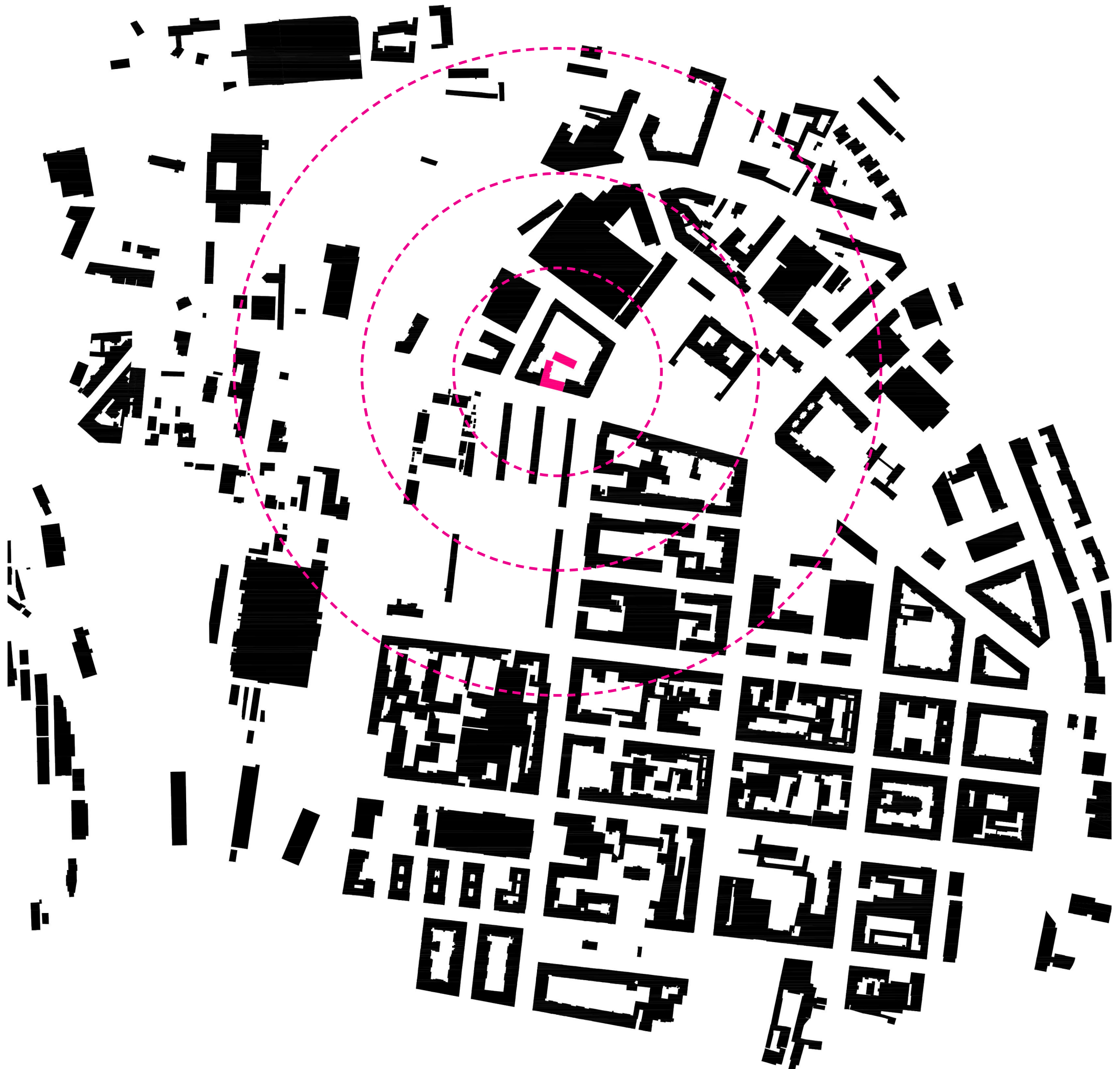

SCHWARZPLAN  
1:5000



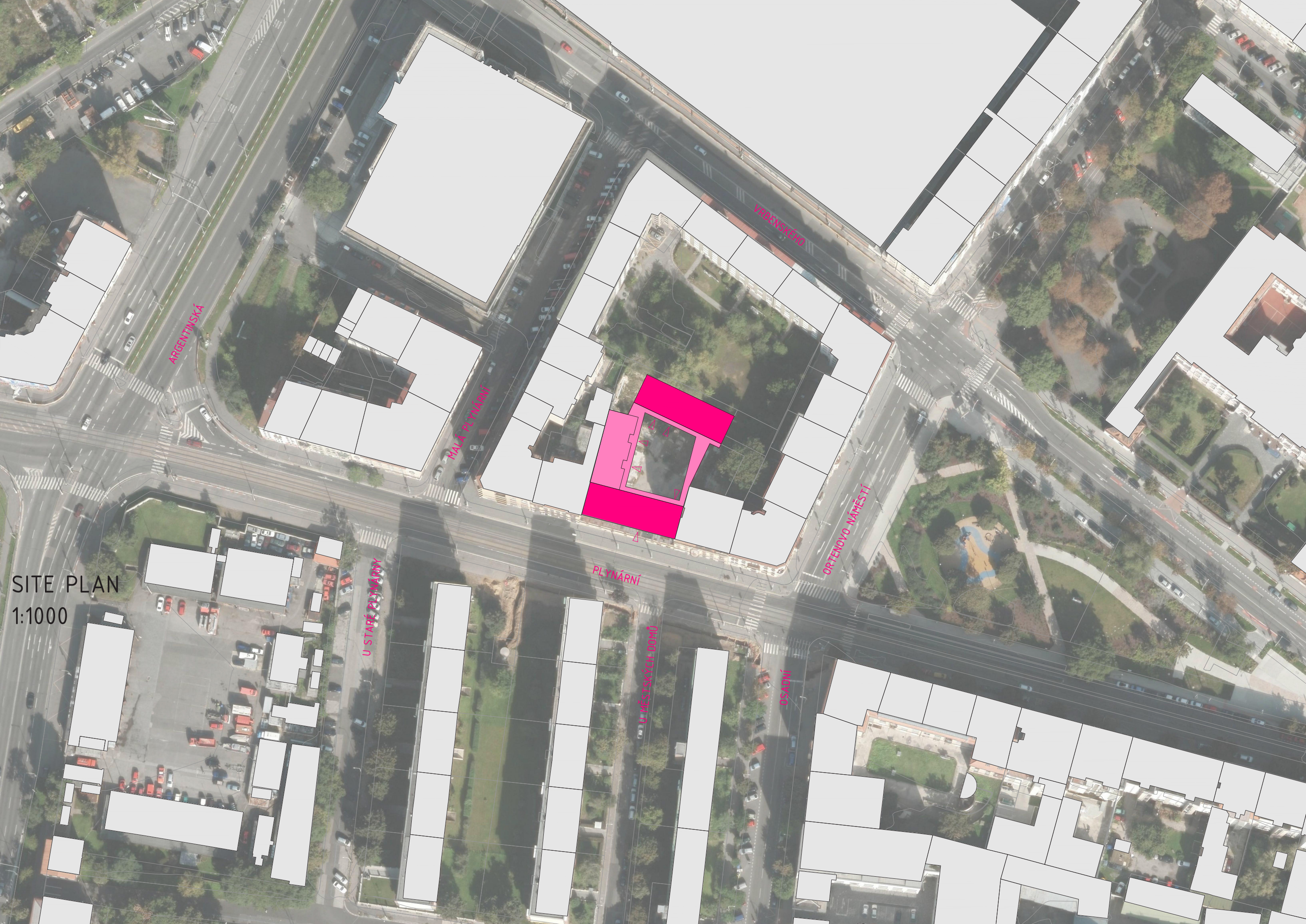

ARGENTINSKÁ

MALÁ PLYNÁRŇ

VRBENSKÉHO

ORTENOVO NÁMĚSTÍ

PLYNÁRŇ

U STARÉ PLYNÁRNY

U MĚSTSKÝCH DOMŮ

ÚSAZNÍ

SITE PLAN  
1:1000



GOAL OF THE SHELTER  
Offer of  
a comeback to the society.





SHELTER

CISIS ROOMS

INTEGRATION - MIXTURE

SOCIAL FLATS

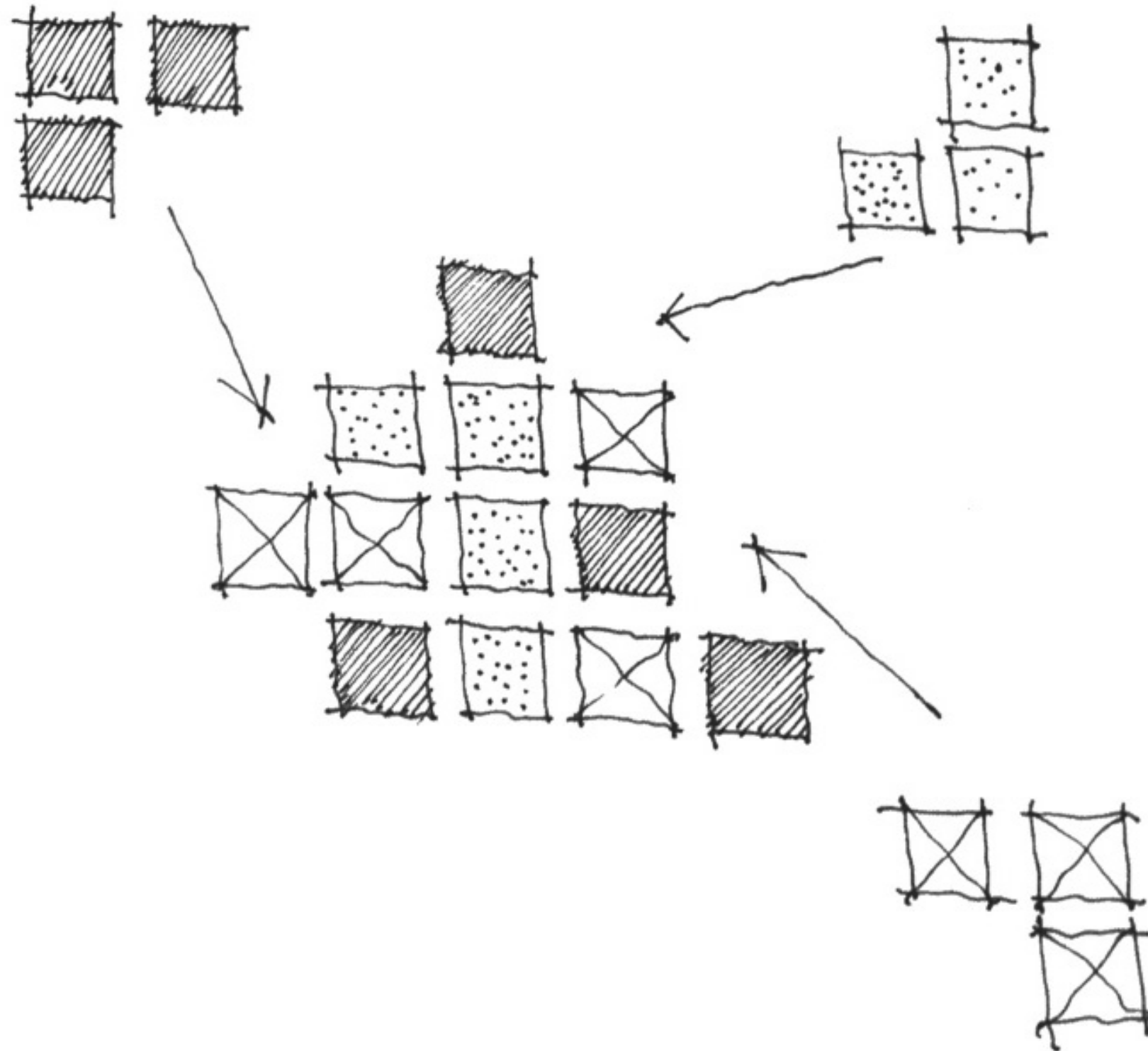



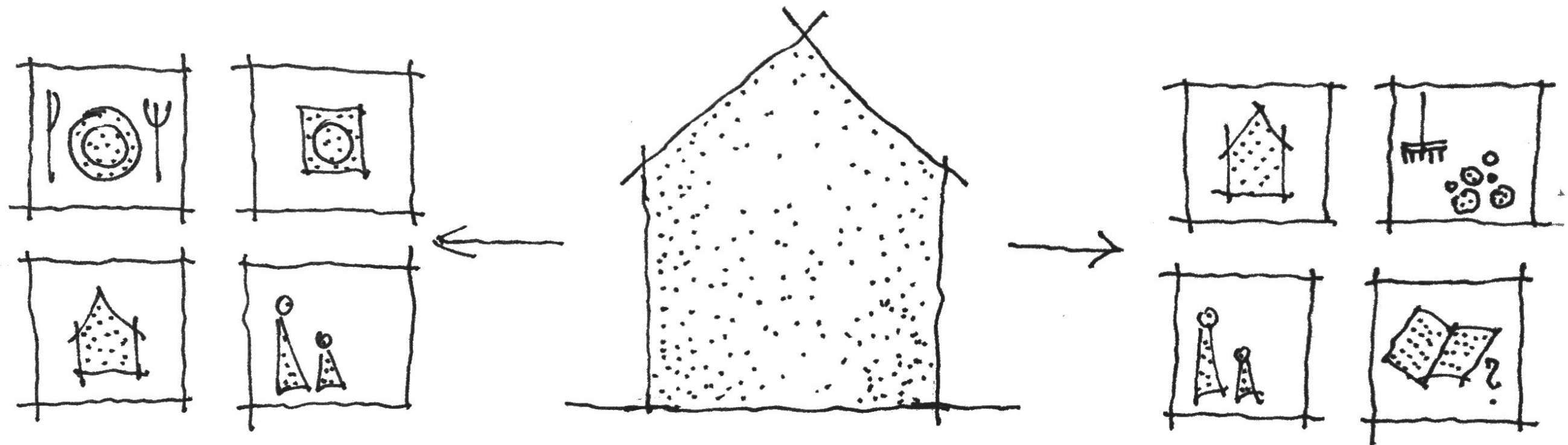

## A HOUSE FOR EVERYBODY

A house which has what to offer to the society  
as well as to the residents.



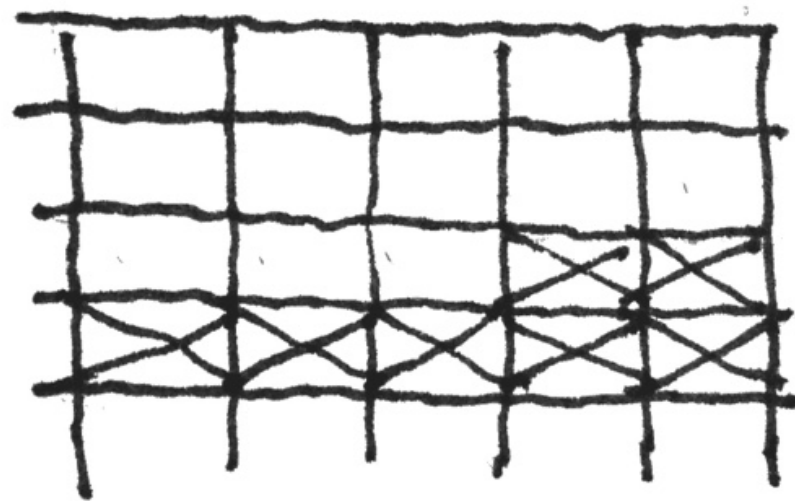

1

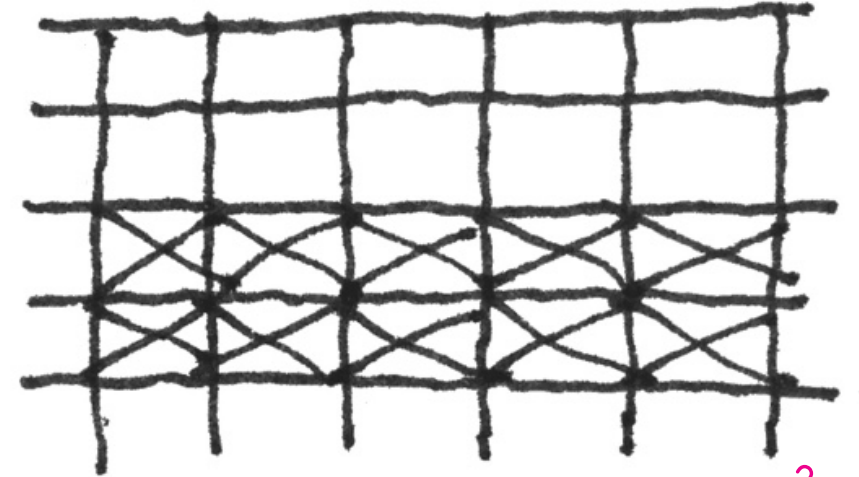

2

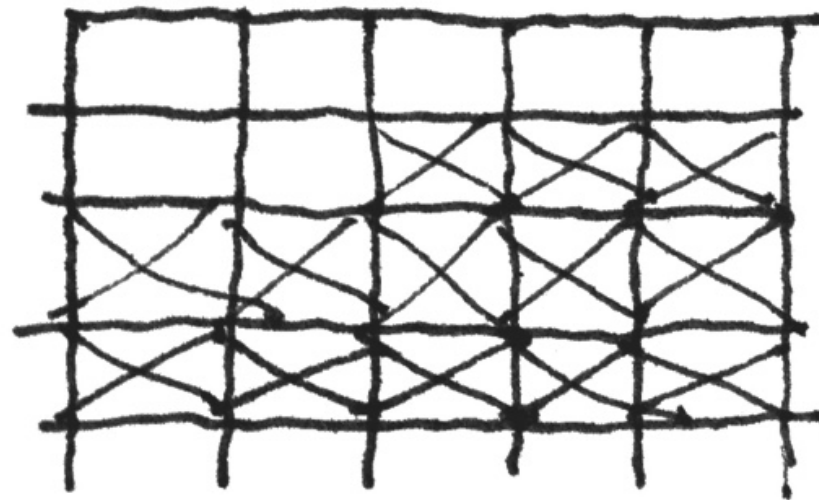

3

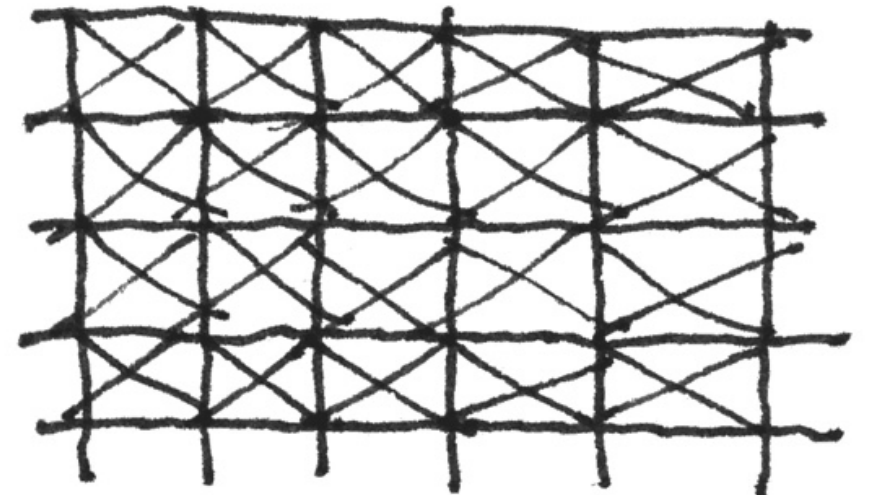

4

STEP-BY-STEP BUILDING-UP  
House reacts to an actual demand.  
Financial help.  
Integration: neighbours.



INDEPENDENCE OF THE CONSTRUCTIONS  
Framework + prefeab walls

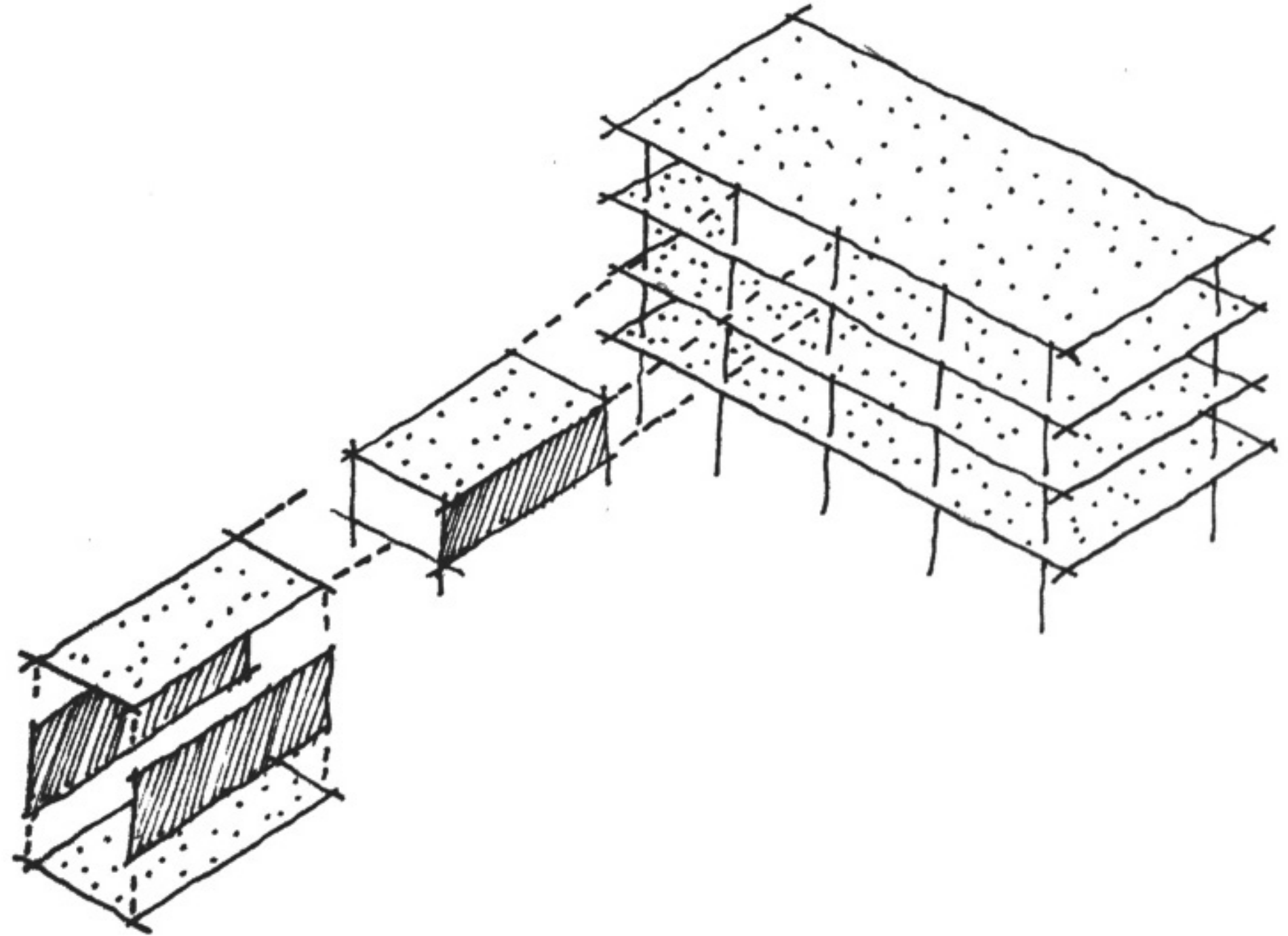



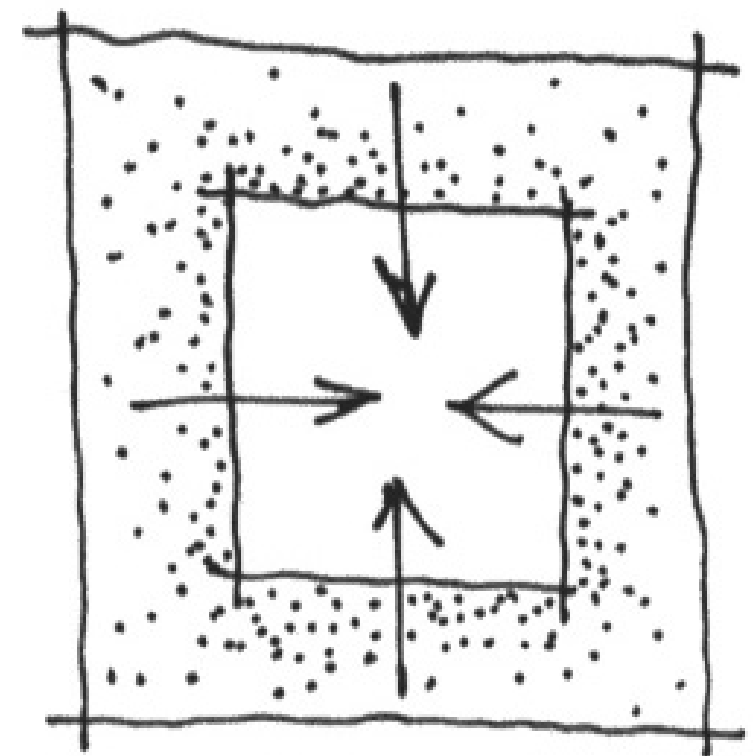
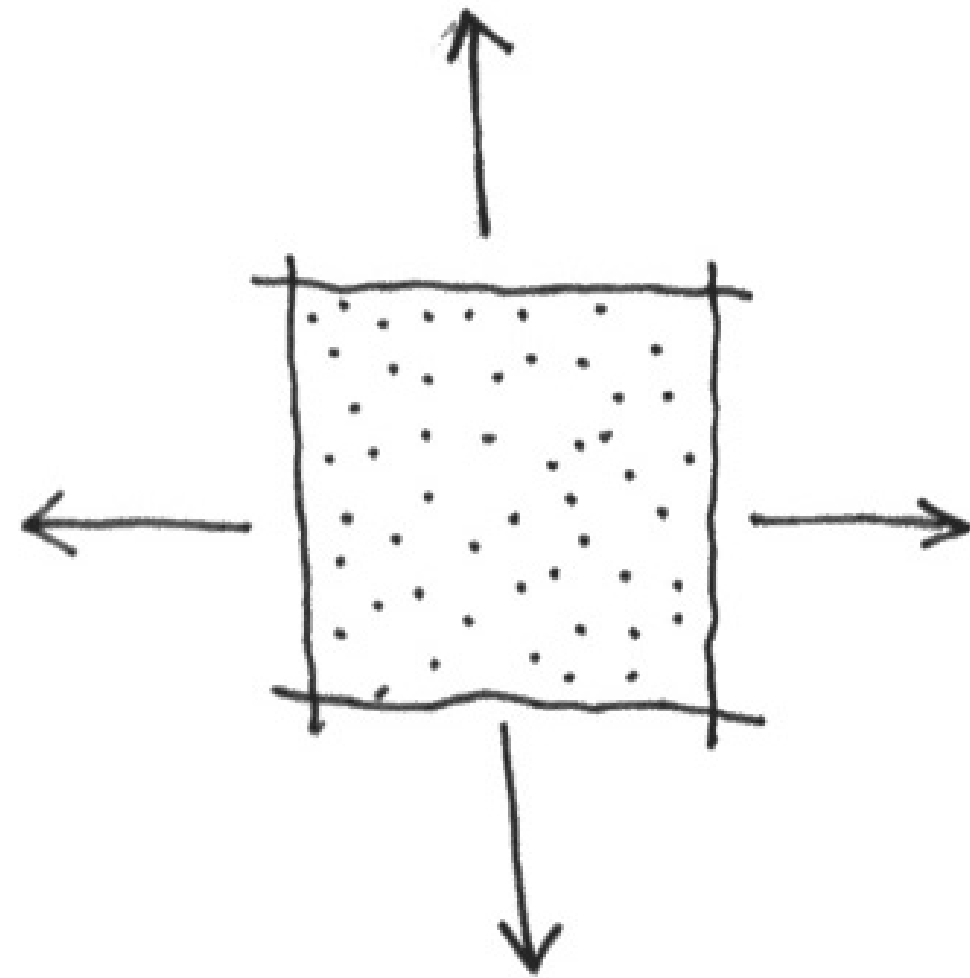

HEART OF THE HOUSE

Not closed house but an open yard.



OPENING OF THE HOUSE  
Everybody is welcomed in the yard.

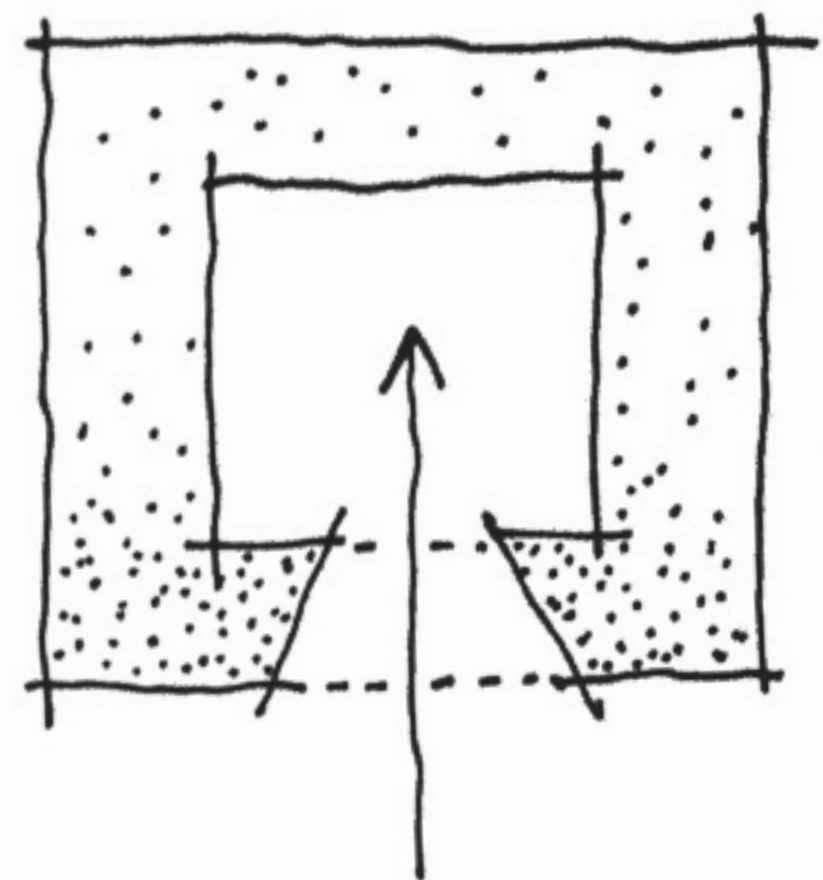
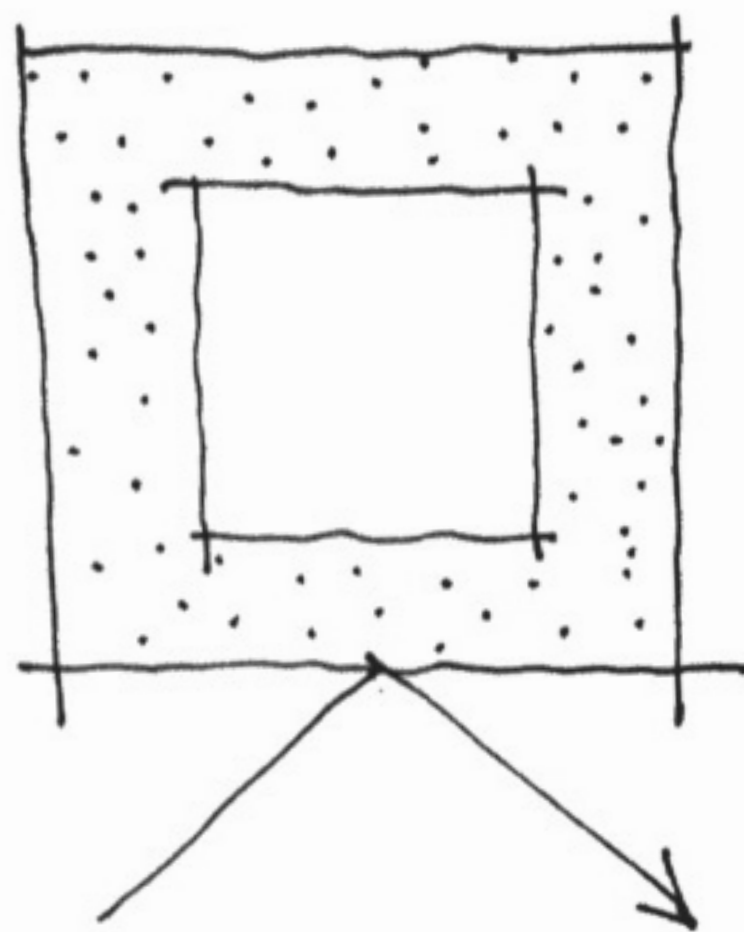



# HIERARCHY OF PLACES

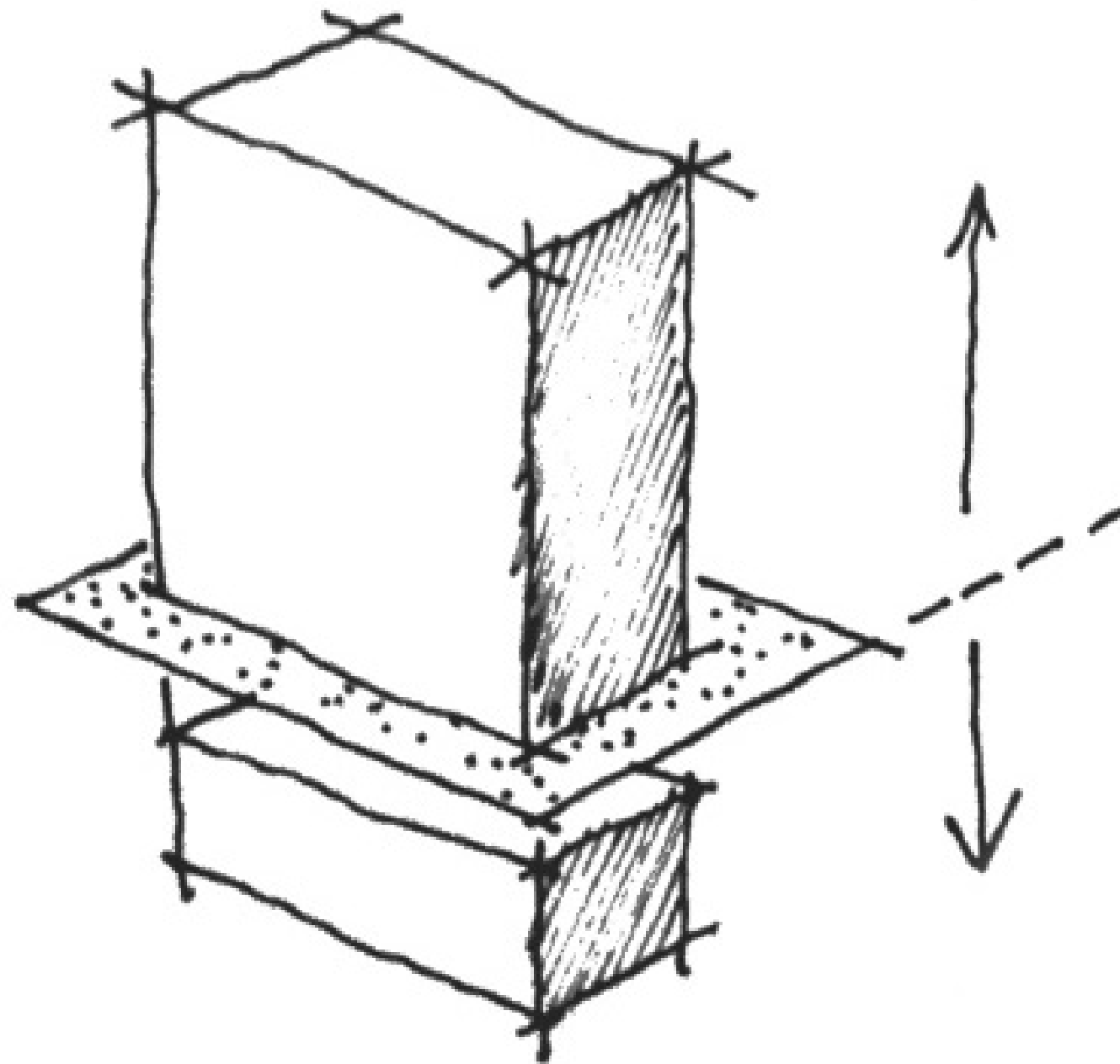

PRIVATE HOUSING

SEMI-PRIVATE TERRACE

PUBLIC PARTERRE



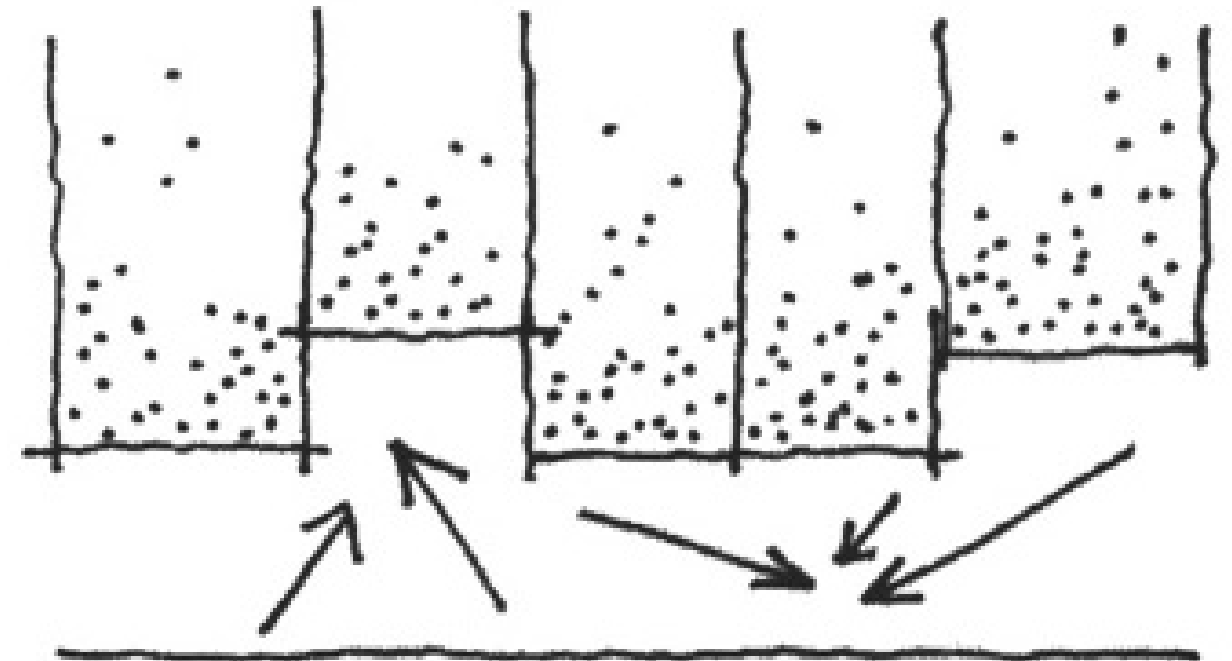
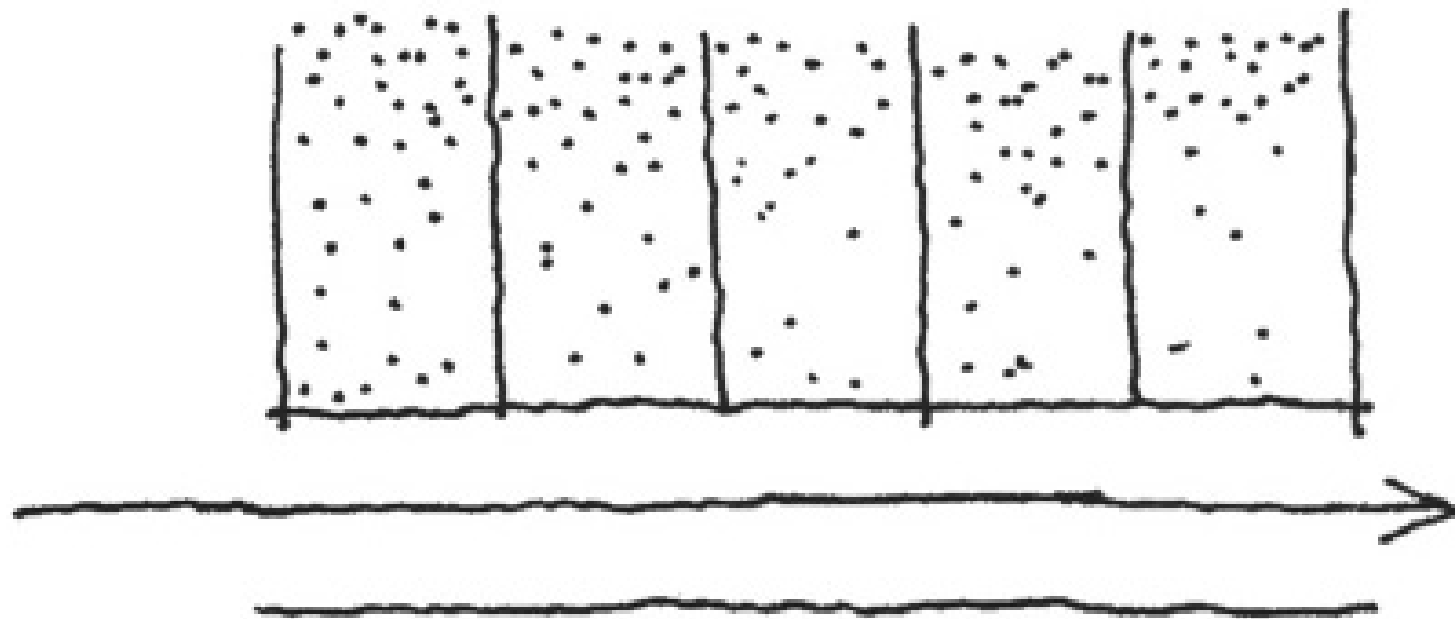

PLACES TO MEET

Three types of a housing unit creates a dynamic porch.







GROUND PLAN

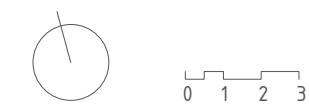



GROUND PLAN

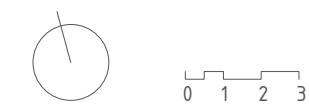



GROUND PLAN

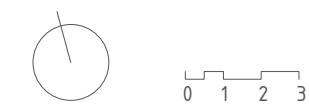



GROUND PLAN

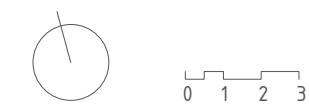



GROUND PLAN

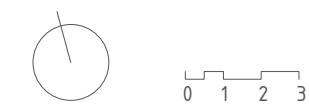







GROUND PLAN

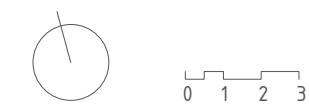



GROUND PLAN

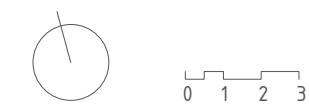



GROUND PLAN

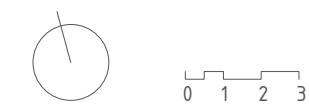



GROUND PLAN

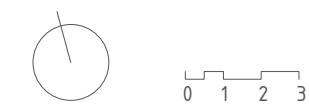



GROUND PLAN

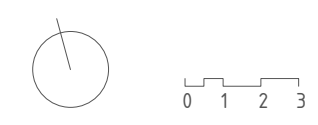



GROUND PLAN

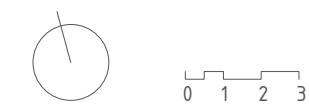



2nd FLOOR PLAN

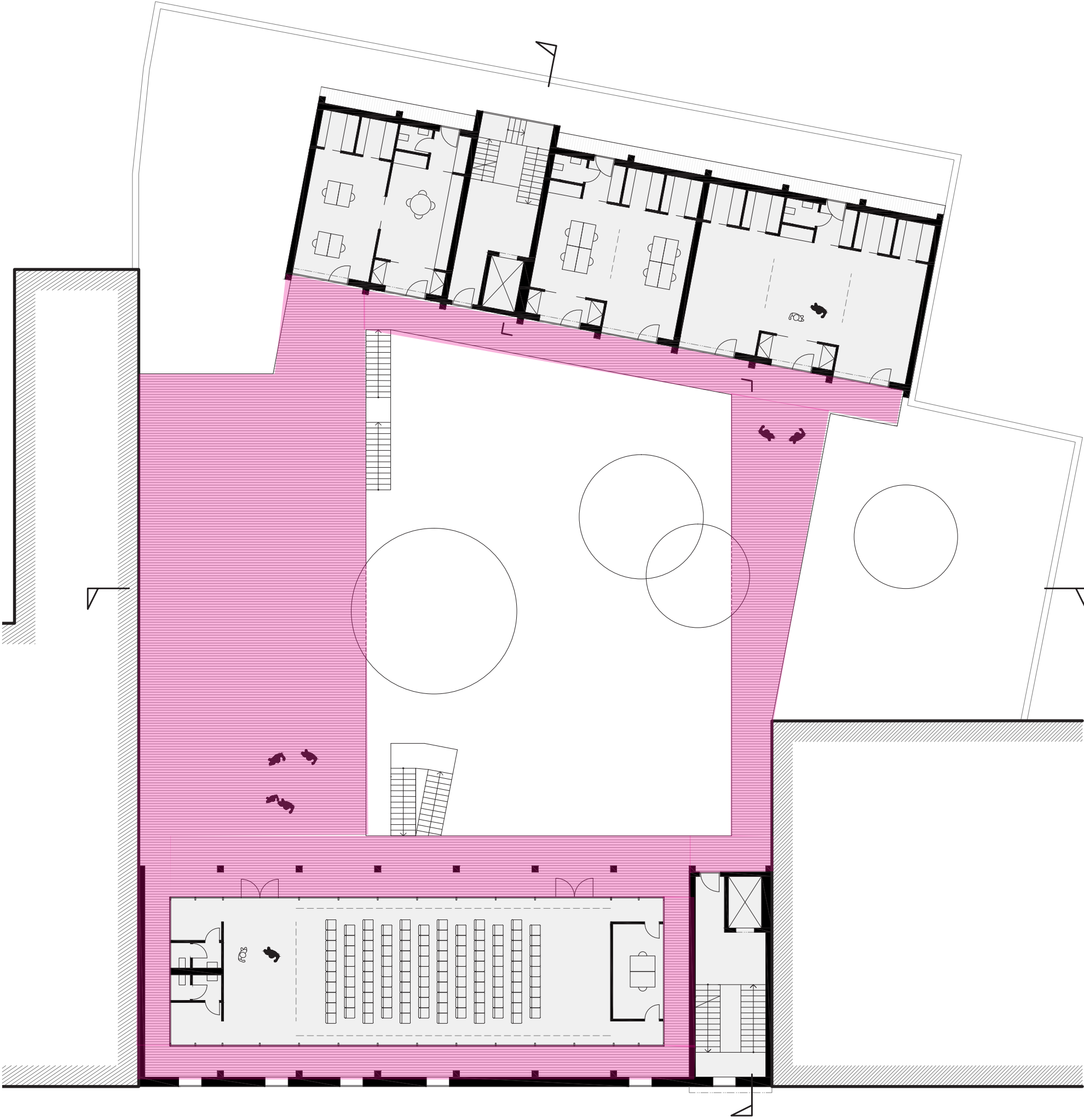







2nd FLOOR PLAN

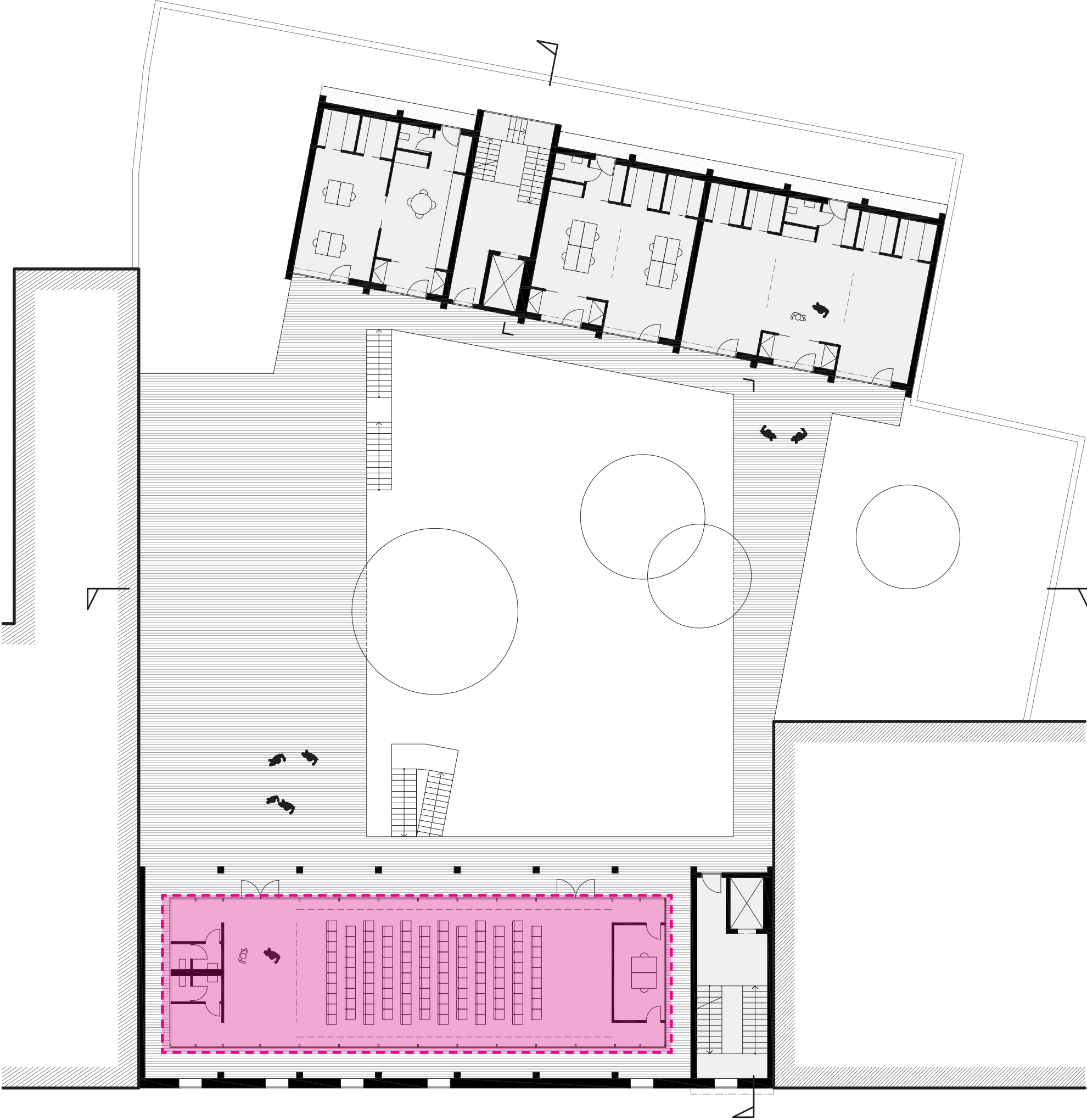
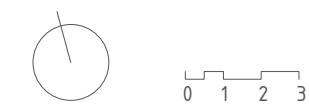



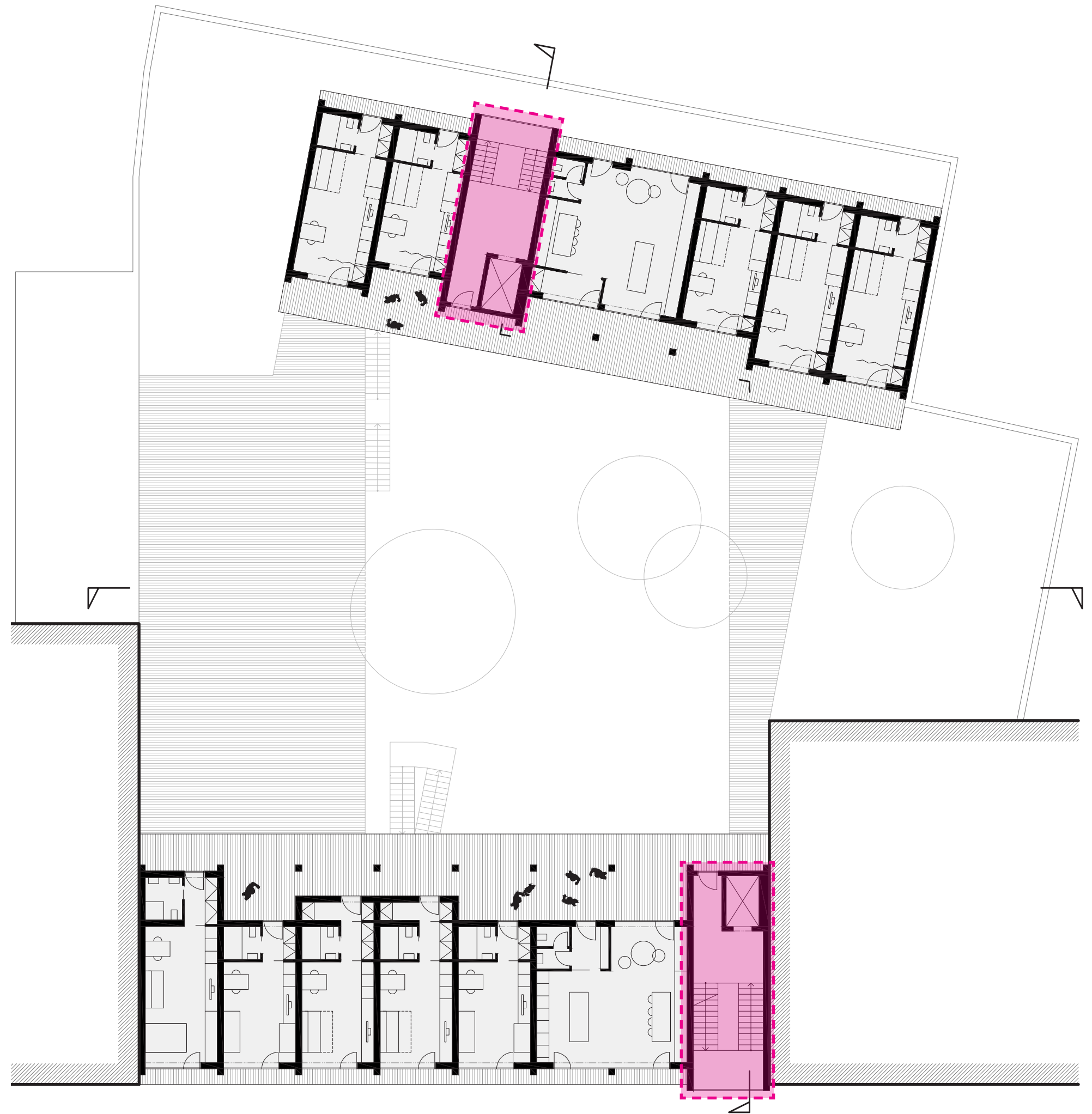

3rd FLOOR PLAN  
(typical completed floor plan)



0 1 2 3







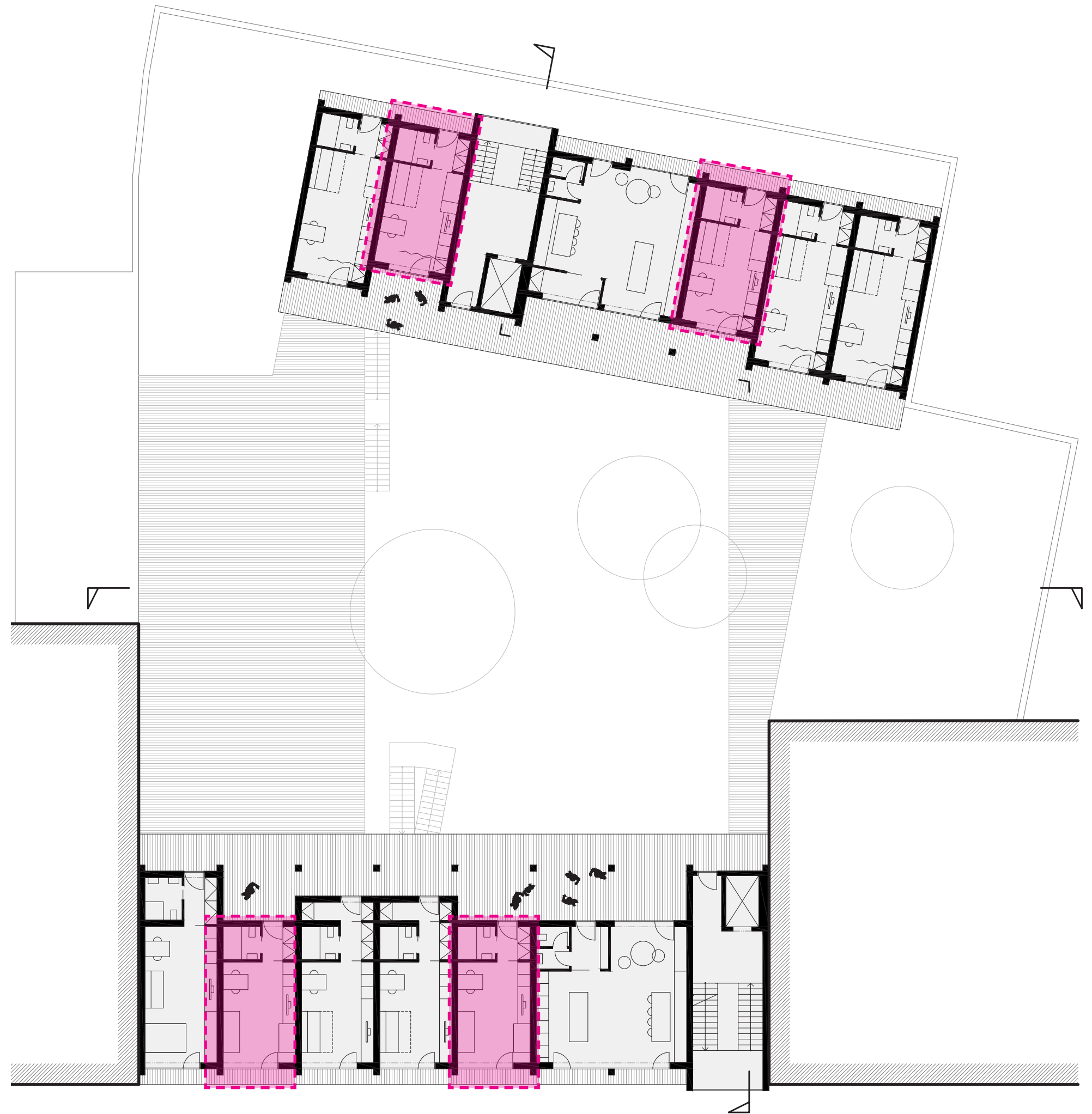

3rd FLOOR PLAN  
(typical completed floor plan)



0 1 2 3



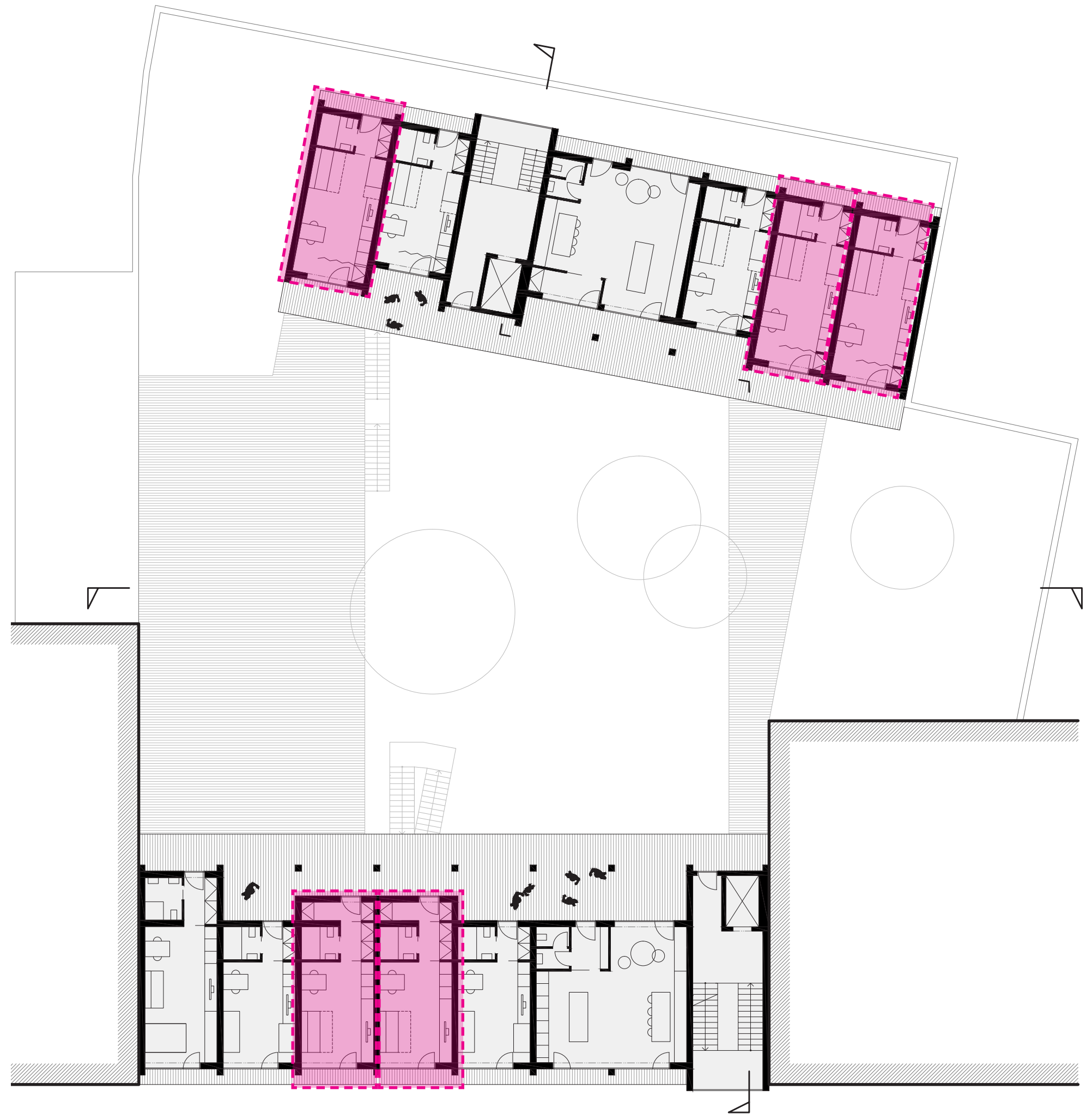

3rd FLOOR PLAN  
(typical completed floor plan)



0 1 2 3



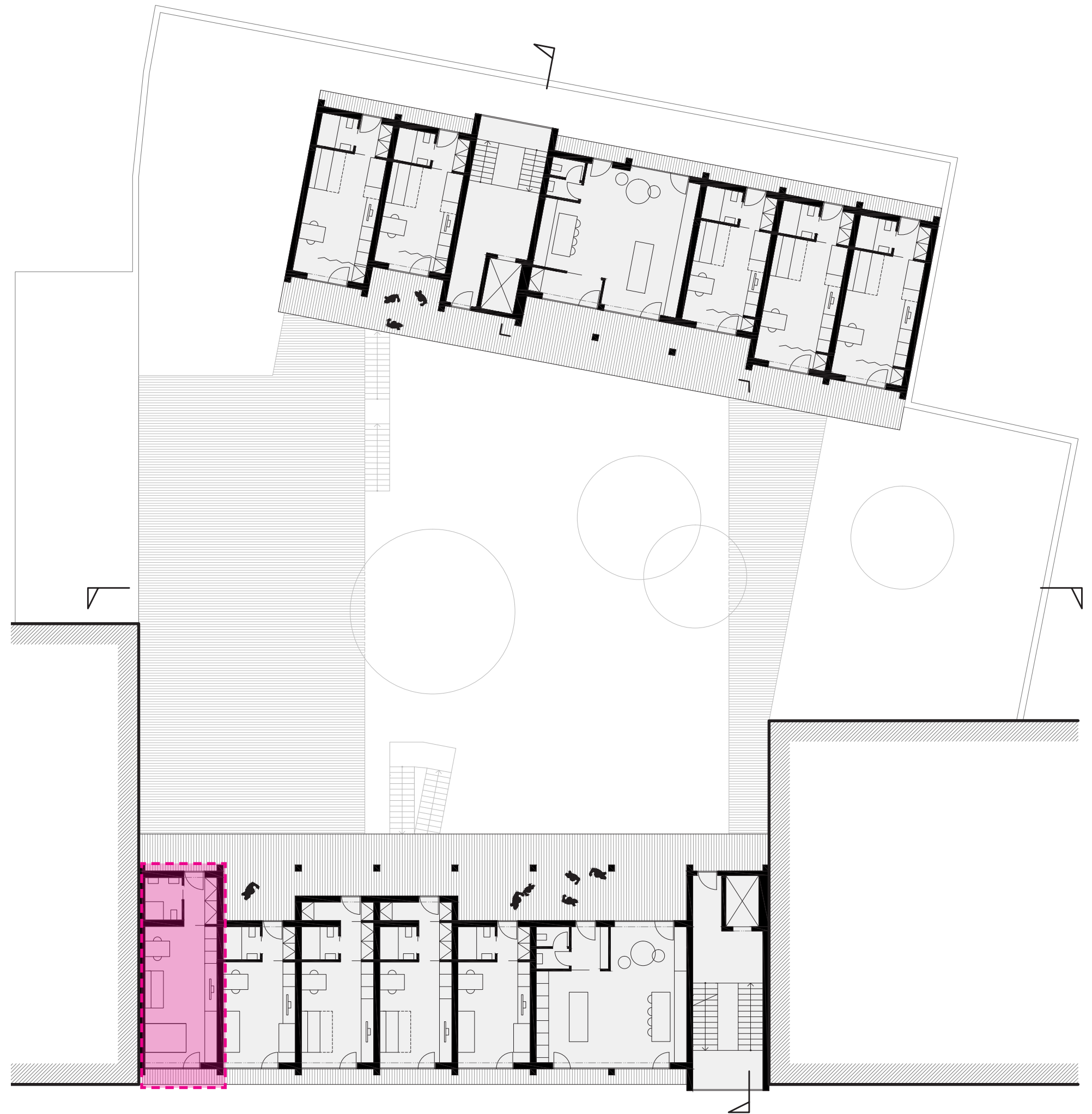

3rd FLOOR PLAN  
(typical completed floor plan)



0 1 2 3



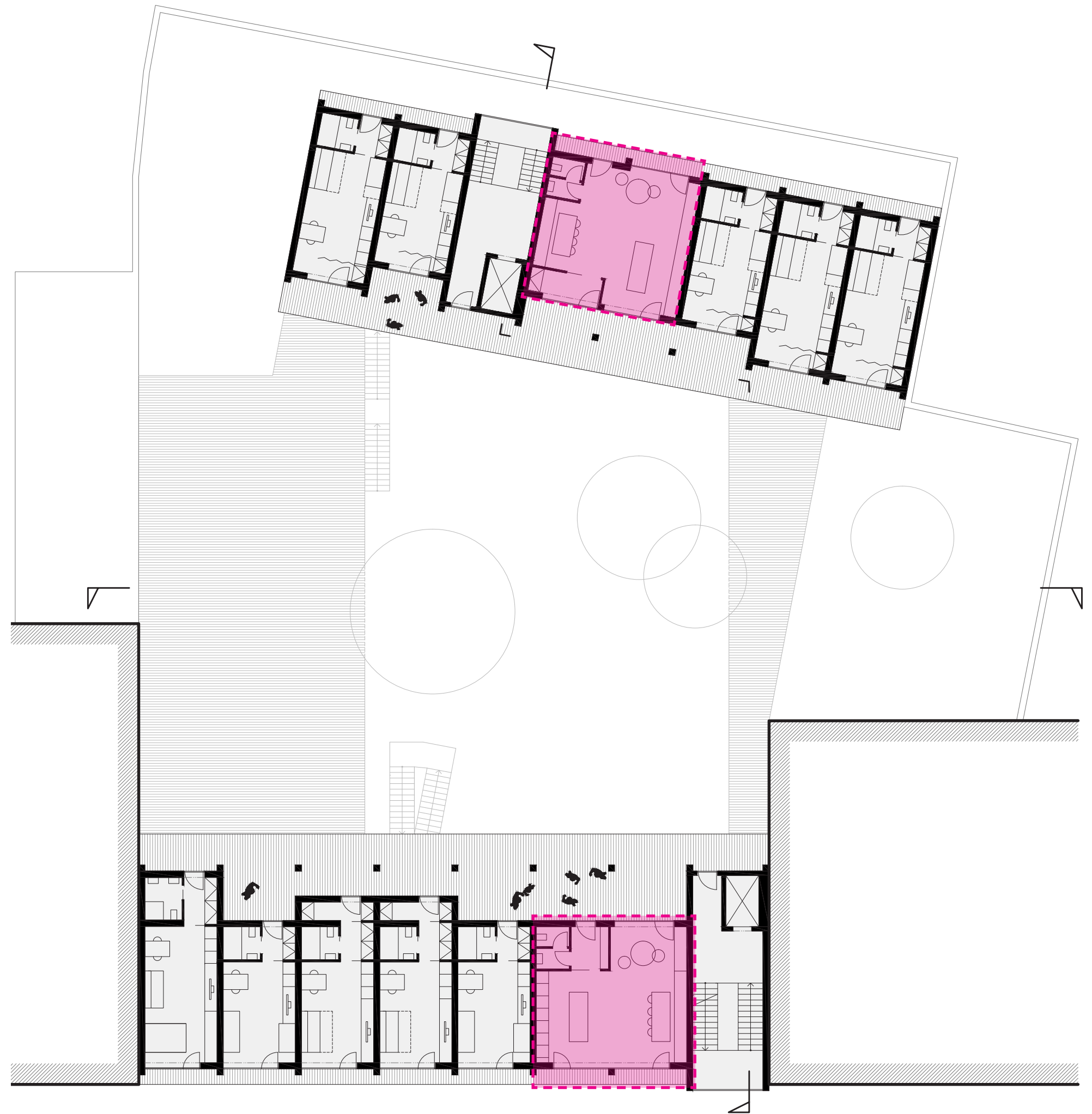

3rd FLOOR PLAN  
(typical completed floor plan)



0 1 2 3







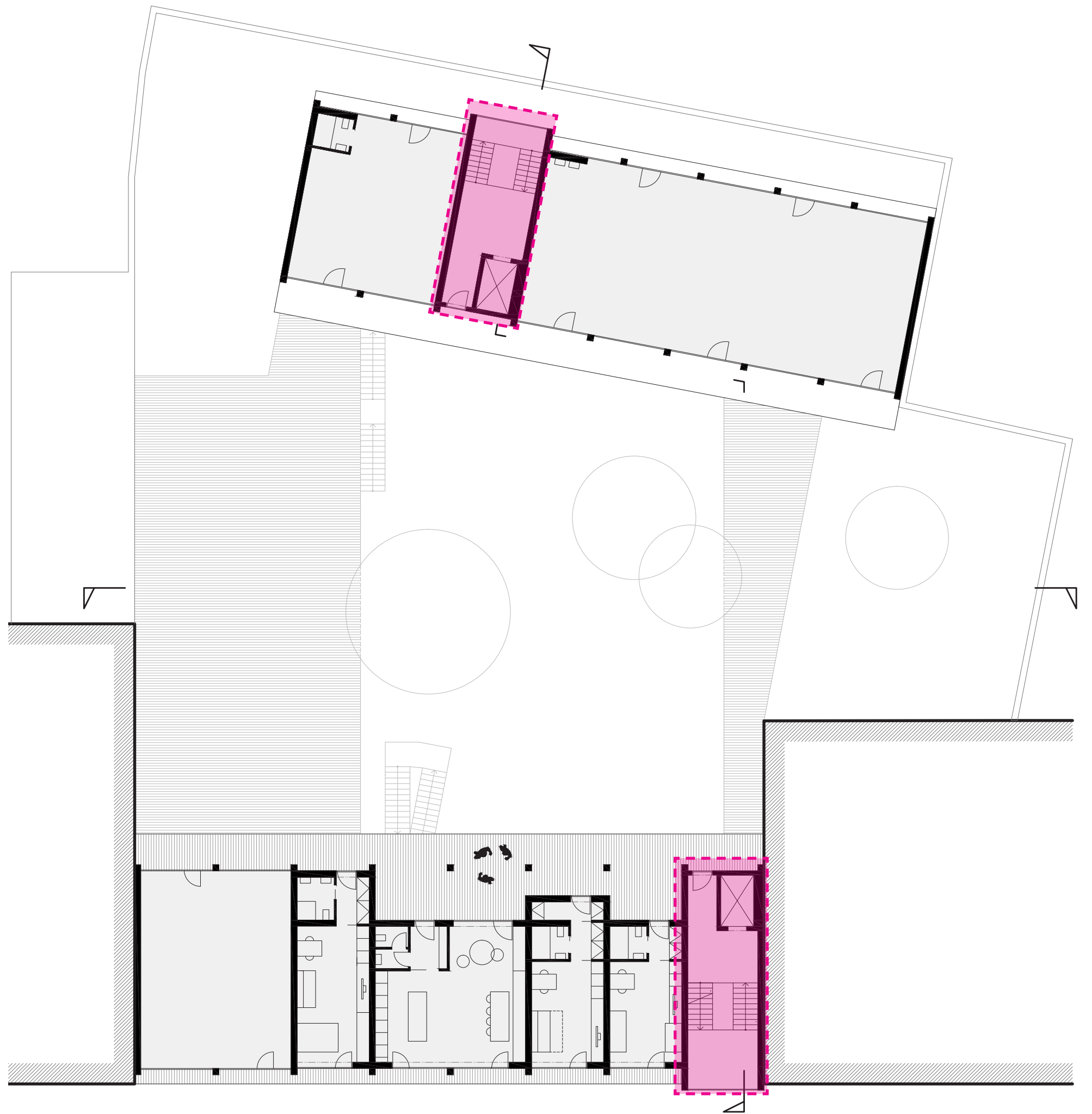

4th FLOOR PLAN  
(typical uncompleted floor plan)



0 1 2 3



4th FLOOR PLAN  
(typical uncompleted floor plan)

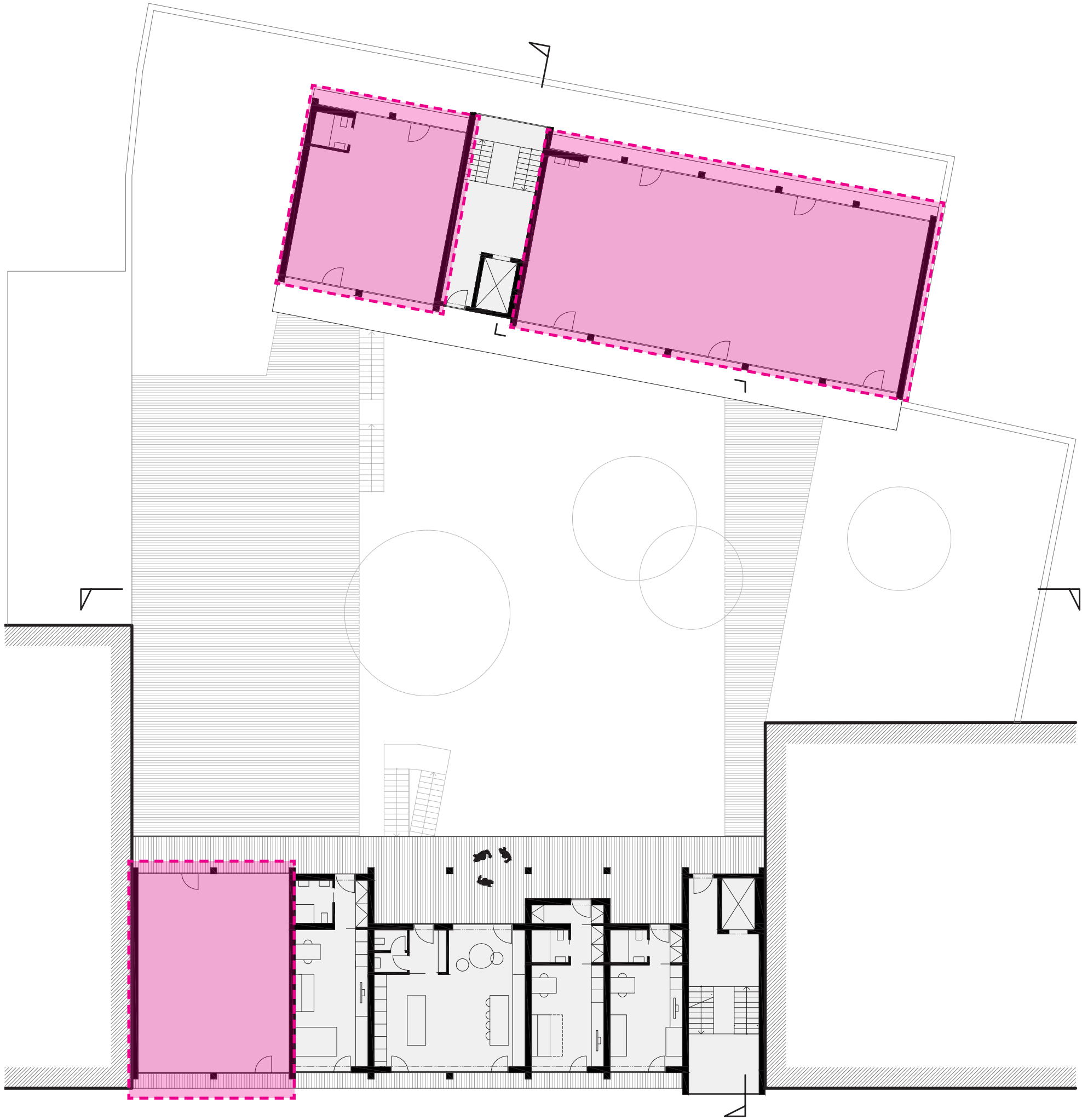
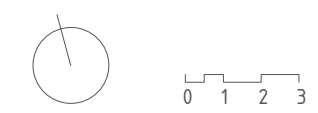



SUMMARY OF MAIN GOALS  
re-integration of homeless people  
benefit for surroundings  
reaction to an historical object







THANK YOU.

[karolina.kripnerova@gmail.com](mailto:karolina.kripnerova@gmail.com)